

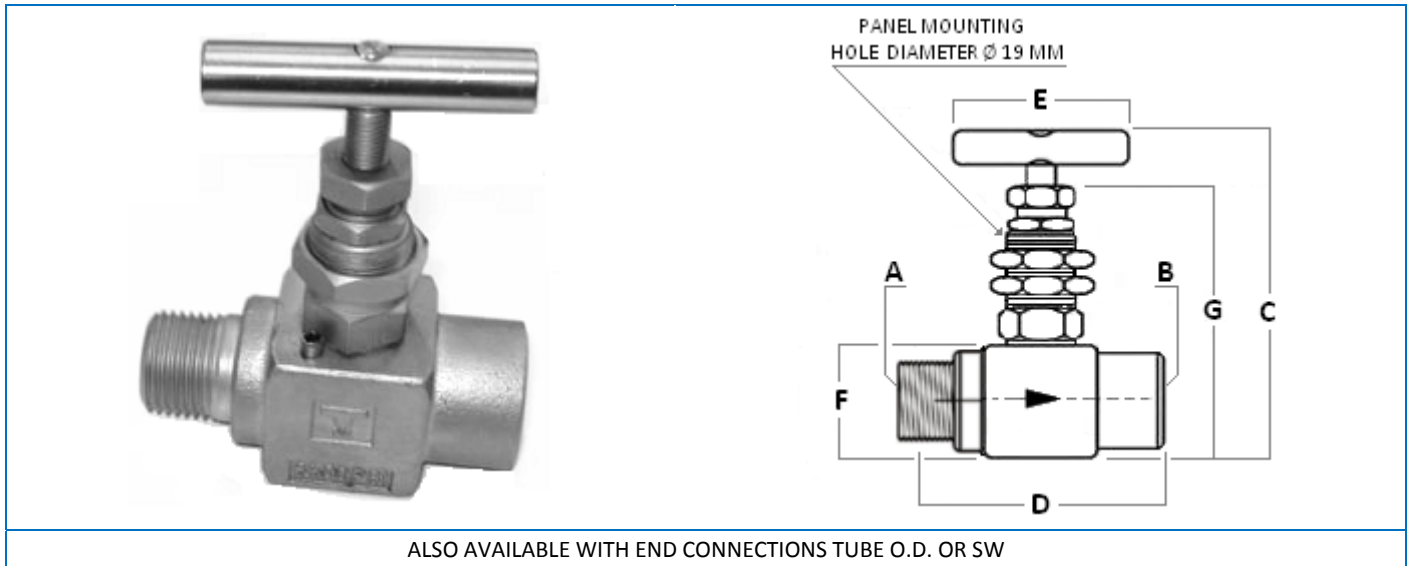

Needle Valves 400MFP Series

Male Thread to Female Thread – 1 Way – for panel



PART NUMBER	SS 316	404 MFP 316	404 MFBP 316	406 MFP 316	406 MFBP 316	408 MFP 316	408 MFBP 316	
	CARBON	404 MFP S	404 MFBP S	406 MFP S	406 MFBP S	408 MFP S	408 MFBP S	
END CONNECTIONS	ENTRADA (A)	1/4" NPT MALE	1/4" BSP MALE	3/8" NPT MALE	3/8" BSP MALE	1/2" NPT MALE	1/2" BSP MALE	
	SAÍDA (B)	1/4" NPT FEMALE	1/4" BSP FEMALE	3/8" NPT FEMALE	3/8" BSP FEMALE	1/2" NPT FEMALE	1/2" BSP FEMALE	
DIMENSIONS*	C	OPEN: 90,00 CLOSED: 87,00						
	D	65,50				72,75		
	E	55,00						
	F	31,75						
	G	67,50						

* Dimensions are for reference only and are subject to change.

OPTIONALS & KEY FEATURES	
VARIOUS STANDARD END-CONNECTIONS FROM 1/8" TO 1"	17-4 PH STAINLESS STEEL NON-ROTATING STEM TIP
CHOICE OF 316 STAINLESS STEEL (CF8M) OR CARBON (WCB)	NPT THREADS OR BSP THREADS – MM OR INCHES
TEFLON® PACKING OR GRAFOIL® PACKING	MAXIMUM OPERATING PRESSURE: 6.500 PSI
STRAIGHT AND ANGLE PATTERNS	JOINT IS LOCATED ABOVE THE PACKING, PROTECTED FROM SYSTEM

Technical Standards



STANDARDS – RAW MATERIAL		400 MFP
		COMPONENTES DA VÁLVULA
Nº	SS 316 (316)	CARBON (S)
1	ROUND BAR (316)	ROUND BAR (S)
	ASTM A 276	SAE 1020 / 1045
2	SCREW ALLEN (304)	SCREW ALLEN (S)
	DIN 915	DIN 915
3	HEX BAR (316)	HEX BAR (S)
	ASTM A 276	SAE 1020 / 1045
4	HEX BAR (316)	HEX BAR (S)
	ASTM A 276	SAE 1020 / 1045
5	WASHER (316)	
	ASTM A 167	
6*	PTFE 850A (TEFLON®)	
	ASTM D 4894	
	GRAFKOTE (GRAFOIL®)	
	ASTM F 1315	
7	HEX BAR (316)	HEX BAR (S)
	ASTM A 276	SAE 1020 / 1045
8	PTFE 850A (TEFLON®)	
	ASTM D 4894	
9	ROUND BAR (316)	
	ASTM A 276	
10	ROUND BAR ARMCO 17-4 PH	
	ASTM A 564 TP 630	
11*	HEX BAR(316)	
	ASTM A 276	
12	SPRING PIN (304)	SPRING PIN (S)
	DIN 1481	DIN 1481
13*	BODY VALVE (CASTING) (CF8M)	
	BODY VALVE (CASTING) (WCB)	
	ASTM A 351	ASTM A 216
	SQUARE BAR (316)	SQUARE BAR (S)
ASTM A 276		SAE 1020 / 1045

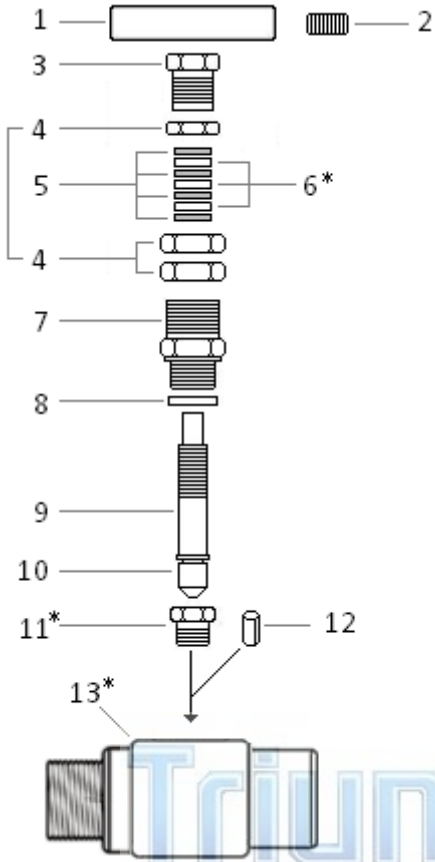

* OPTIONAL

VALVES BODIES TREATMENT		
COMPONENT	TREATMENT	STANDARD
ALL (EXTERNALS)	SS 316 (CF8M)	GLASS BEAD BLASTING
	CARBON (WCB)	
		TRIUNION'S STANDARD

OXYGEN CLEANING		
COMPONENT	TREATMENT	STANDARD
ALL	SS 316 (CF8M)	ROCOL® FLUOR CLEAN OR SIMILAR
	CARBON (WCB)	
		ASTM G 93

PRESSURE TESTING			
PRODUCTS	TESTING PROCEDURES		STANDARD
	SHELL	SEAT	
VALVES	9.750 PSI – 15 SEC ROOM TEMPERATURE	7.150 PSI – 15 SEC ROOM TEMPERATURE	MSS SP 82 BS EN 12266

Technical Information

Valves for Panel – 400P Series – 1 way



TECHNICAL DATA		SS 316	CARBON	
S T A N D A R D S	CONSTRUCTION		BODY: ASME B 16.34	
			END CONNECTION: ASME B 16.11	
	RAW MATERIAL (ASME B 31.1)	BODY (OPTIONAL)	SS 316 - CASTING (CF8M) – ASTM A 351	CARBON - CASTING (WCB) – ASTM A 216
			BAR ASTM A 276 TP 316	BAR SAE 1020 / 1045
		NEEDLE	ARMCO 17-4 PH – ASTM A 564	
		PACKING (OPTIONAL)	GASKETS: CHOICE OF TEFLON® (POLYACETAL) OU GRAFOIL®	
INTERNAL	ALL SS 316 - ASTM A 276			
PANEL MOUNTING HOLE DIAMETER		Ø 19 MM		
CONSTRUCTIVE FORM OF THE STEM		SINGLE PIECE WITHOUT WELDING		
HANDLE		T-BAR SS 304 / SS 316 Ø – ASTM A 276	T-BAR CARBON Ø – SAE 1020 / 1045	
ACTUATOR		DIRECT BY HANDLE		
TYPE		NEEDLE TYPE GLOBE VALVE		
SEAT		METAL SEAL BETWEEN BODY AND BONNET REPLACEABLE		
NEEDLE TIP		NON ROTATING TIP – SELF CENTERING AND ANTI-GALLING		
END CONNECTIONS FOR TUBE O.D.		TWO FERRULES SYSTEM		
WORKING PRESSURE		6.500 PSI (MAXIMUM)		
ORIFICE SIZE / CV		Ø 4 MM / CV 0.36 (MAXIMUM)		
BURST PRESSURE		DESIGNED WITH 4 : 1		
TEMPERATURE RANGE (OPTIONAL PACKING)		TEFLON® = (-) 50° C A + 200° C GRAFOIL® = (-) 50° C A + 600° C		
TESTING PROCEDURES		STANDARDS BS EN 12266-1:2003 / BS EN 1266-2:2003 / MSS-SP-82 100% FACTORY TESTED 9.750 PSI – 15 SEC – ROOM TEMPERATURE		
KEY FEATURES				
HIGH PRESSURE CAPABILITY, 316 STAINLESS STEEL OR CARBON VALVE MAXIMUM WORKING PRESSURE IS 6.500 PSI (448 BAR) AT ROOM TEMPERATURE.				
PACKING STEM SEATS BELOW STEM THREADS, TO PROTECT STEM THREADS FROM ABRASIVE FLUIDS.				
REPAIR SEAT KIT ON AVAILABLE TO EXCHANGE				
100% FACTORY TESTED, ALL VALVES HAVE NEEDLE NON-ROTATING HARDNED (17-4 PH) TIPS AS STANDARD.				
DIFERENT TYPE OF THE END CONNECTIONS: DOUBLE FERRULE TYPE, SW, MALE, FEMALE, NPT OR BSP THREADS, INCHES AND MM.				