

NI – Hex Nipple (Male NPT)

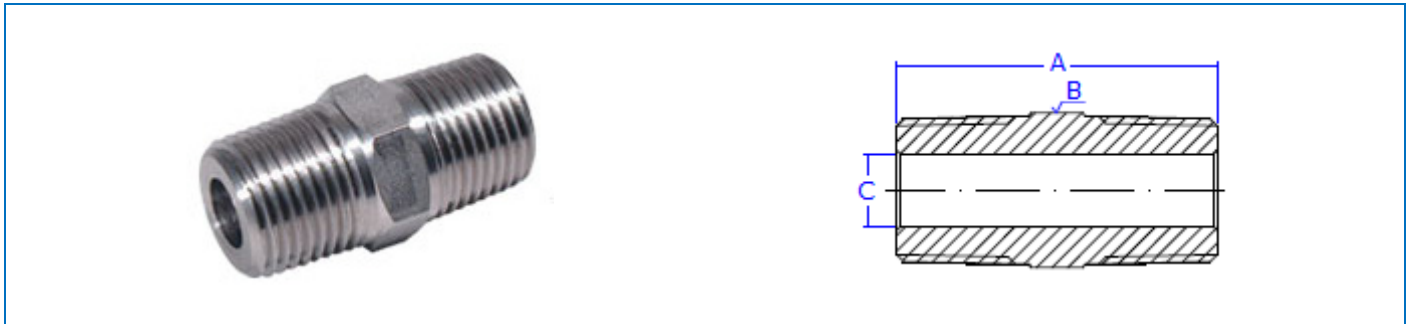
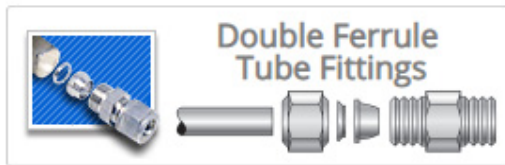

PART NUMBER		NPT THREADS	DIMENSIONS*		
BRASS	SS 316		A	B	Ø C
2 NI	2 NI 316	1/8"	23,40	7/16"	5,00
4 NI	4 NI 316	1/4"	33,40	9/16"	5,00
6 NI	6 NI 316	3/8"	34,40	11/16"	7,50
8 NI	8 NI 316	1/2"	46,00	7/8"	10,50
12 NI	12 NI 316	3/4"	46,00	1.1/16"	15,00
16 NI	16 NI 316	1"	51,00	1.3/8"	16,60
20 NI	20 NI 316	1.1/4"	61,20	1.3/4"	27,68
24 NI	24 NI 316	1.1/2"	63,00	2"	34,00

*Dimensions are for reference only and are subject to change.

OPTIONALS & KEY FEATURES

SIZE RANGES FROM 1/16" THROUGH 1"	FERRULES OF ARMCO 17-4 PH OR DELRIN
FITTINGS ARE STANDARD IN SS 316, BRASS OR CARBON STEEL	AVAILABLE WITH NPT, BSP OR BSP + O'RING VITON
FOR FRACTIONAL TUBE TO METRIC TUBE (INCHES OR MILLIMETERS)	CAN BE USED WITH A WIDE VARIETY OF TUBING MATERIALS INCLUDING PLASTIC OR GLASS TUBES.

STANDARDS

TUBE FITTINGS / ADAPTER FITTINGS

DIMENSIONS	MALE/EXTERNAL	SAE J 514
	FEMALE/INTERNAL	SAE J 1926
	SW	ASME B 16.11
	JIC 37 ^e	SAE J 514
	NPT THREADS	ASME B 1.20.1
	BSP THREADS	DIN ISO 228



NI – Hex Nipple (Male NPT)

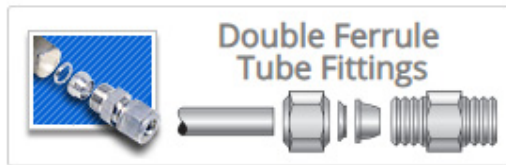

RAW MATERIAL	MATERIALS STANDARDS		ASME B 31.3
	SS 316	BAR STOCK	ASTM A 276
		CF8M	ASTM A 351
	CARBON	BAR STOCK	NBR NM 87 NBR 11294 ASTM A 108
		WCB	ASTM A 216
	BRASS	BAR STOCK	ASTM B 16
		FORGINGS	ASTM B 124 ASTM A 377 ASTM B 283
	ARMCO 17-4 PH - TP 630		ASTM A 564
DELTRIN (POLYACETAL)		ASTM D 4181 ASTM D 792 (ACETALS)	
PROCESS	SILVER-PLATING APPLIED TO THE INTERNAL SURFACE OF THE NUT (SS 316)		TRIUNION'S INTERNAL STANDARD
	ZINC-NICKEL PLATTING		ASTM B 841-99
PRESSURE	TESTING	MSS-SP-25 MSS-SP-83	
	RATINGS	ASME B 31.1 ASME B 31.3	